



5TH

SPACE4WOMEN EXPERT MEETING

INTEGRATING WOMEN IN SPACE ACTIVITIES & SOLUTIONS

27-29 NOVEMBER | 2024

Information for participants



United Nations
Office for Outer Space Affairs



KENYA SPACE AGENCY
Possibilities beyond our skies

Table of contents

CONTENTS

WELCOME!	2
PROGRAMME AT A GLANCE	3
ENTRY INTO KENYA	4
RECOMMENDED ACCOMODATION	5
GETTING TO/FROM THE AIRPORT	8
FOREX EXCHANGE	8
GETTING AROUND NAIROBI	9
VENUE AND FACILITIES	10
THINGS TO DO	11
EMERGENCY SERVICES	12
ADDITIONAL INFORMATION	13



WELCOME!

Congratulations and welcome to the United Nations/Kenya 2024 Space4Women Expert Meeting! This event is jointly hosted by the United Nations Office for Outer Space Affairs (UNOOSA) and the Kenya Space Agency (KSA).

The Space for Women (Space4Women) Expert Meeting series, a capacity-building initiative of the United Nations Office for Outer Space Affairs (UNOOSA), is a pivotal annual gathering aimed at advancing gender equality and empowering women's participation in space-related fields. The initiative encourages women and girls to pursue Science, Technology, Engineering, and Mathematics (STEM) education and raises awareness about career opportunities in the space sector.

The fifth edition of the Space4Women Expert Meeting will be held in Nairobi, Kenya from 27 to 29 November 2024, at the UN Headquarters in Nairobi themed “**Integrating Women in Space Activities and Solutions**”. The meeting will build upon and advance the results of previous meetings held in the United States of America, the United Arab Emirates, the Republic of Korea and Canada.

The meeting is expected to realize the following outcomes:

- Recommend concrete policies and actions towards gender equality and women empowerment in space science, technologies, innovation and exploration, with a focus on grass-root level.
- Dive into the implementation of the Gender Mainstreaming Toolkit to advance the gender-sensitive policy uptake by national space agencies and relevant organizations.
- Increase engagement and advocacy on gender equality in the space sector.
- Equip participants with scalable skills and knowledge on gender mainstreaming in the space sector.
- Increase active participation of women in space activities.
- Identify capacity-building and entrepreneurship opportunities for women in space.

PROGRAMME AT A GLANCE

9:00AM 10:30PM 12:30PM 3:00PM 5:00PM

○ ————— ○ ————— ○ ————— ○ ————— ○

27 NOVEMBER

DAY 1

WELCOME SESSION
THE SPACE4WOMEN PROGRAMME - TODAY & TOMORROW

QUANTITATIVE DATA ON WOMEN PARTICIPATION INTO THE SPACE WORKFORCE: THE LANDMARK STUDY ON GENDER IN THE GLOBAL SPACE FORCE

SYSTEMIC BARRIERS TO GENDER EQUALITY INTO THE GLOBAL WORKFORCE: FROM QUANTITATIVE TO QUALITATIVE APPROACH

PANEL: CHAMPIONING THE IMPLEMENTATION OF THE GENDER MAINSTREAMING TOOLKIT:
ADVANCING THE GENDER-SENSITIVE POLICY UPTAKE

PANEL: UNLOCKING WOMEN'S ACCESS TO LEADERSHIP IN THE SPACE SECTOR

PANEL: SPACE EXPLORATION FOR ALL: ANALOGUE MISSIONS AS A TOOL FOR INNOVATION IN FAVOR OF GENDER-EQUALY

RECEPTION

TRADEMARK
HOTEL, 2ND
FLOOR BACK
TERRACE

28 NOVEMBER

DAY 2

SESSION: EDUCATION AT GRASS-ROOT LEVEL: ACTIONABLE INITIATIVES

PANEL: EMPOWERING WOMEN IN SPACE RESEARCH AND INNOVATION

PANEL: SHARING ACTIONABLE AND TAILORED CAPACITY-BUILDING SOLUTIONS FOR REACHING GENDER EQUALITY IN SPACE AND STEM

STORY-TELLING SEGMENT

RESEARCH WORKSHOP: TECHNOLOGY EDUCATION TO BUILD STEM CAPACITIES OF WOMEN AND GIRLS AT GRASS-ROOT LEVEL

29 NOVEMBER

DAY 3

PANEL: ENTREPRENEURSHIP FOR WOMEN IN THE SPACE SECTOR: THE KEYS FOR SUCCESS

STORY-TELLING SEGMENT

RESEARCH WORKSHOP

PANEL: RAISING GLOBAL AWARENESS: SUCCESSFULLY LEADING OUTREACH INITIATIVES

DRAWING RECOMMENDATIONS TO TAKE ACTION AND FINAL REPORTING SESSION

CLOSING REMARKS



UNITED NATIONS COMPLEX UN AVENUE, GIGIRI, NAIROBI - ROOM CR4

ENTRY INTO KENYA

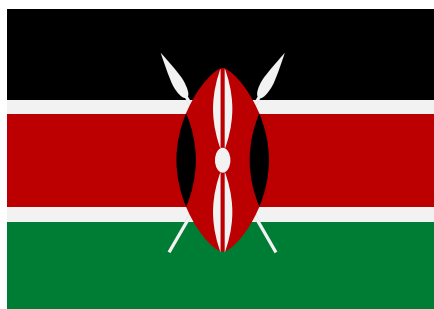

KENYA ENTRY REQUIREMENTS

Visa must be requested through the official eVisa platform:

https://www.etakenya.go.ke/en/pages/GENERAL_INFO. Request shall be processed within 3/4 working days.

ARRIVAL TO KENYA

In order to facilitate entry formalities upon arrival in Kenya, it is strongly recommended that participants carry a copy of the invitation letter signed by UNOOSA that demonstrates that they are participants at the 2024 UN/Kenya Space4Women Expert Meeting, and that they identify themselves as such to the Kenyan authorities.

RECOMMENDED ACCOMMODATION

Below are our suggested hotels with pre-negotiated rates for the Expert Meeting. You may directly contact the hotels to the indicated email address mentioning your participation to the 5th Space4Women Expert Meeting or enter the booking code to benefit on the negotiated rates.

Please note that funded participants will be accommodated at the Trademark Hotel, Limuru Road, Village Market, Gigiri, Nairobi.



Scan the QR code for directions to and from UNON Headquarters.

Trademark Hotel - Bed & Breakfast: USD 150/night (18 minute walk / 4 min drive to the conference venue)

Reservation: salescoordinator@tribehotelsgroup.com



RECOMMENDED ACCOMMODATION

Tribe Hotel , Limuru Road - Bed & Breakfast: USD 240/night (21 minute walk / 5 min drive to the conference venue)

Reservation: salescoordinator@tribehotelsgroup.com



Gigiri Lion Villas 2 - 238 Gigiri drive- Bed & Breakfast: USD 150/night (5 minute walk to the conference venue)

Reservation: sales@glv.co.ke



RECOMMENDED ACCOMMODATION

Mövenpick Hotel , Westlands - Bed & Breakfast: USD 150/night
(18 minute drive to the conference venue)

Booking Block Code: 2411KENYAS



GETTING TO/FROM THE AIRPORT

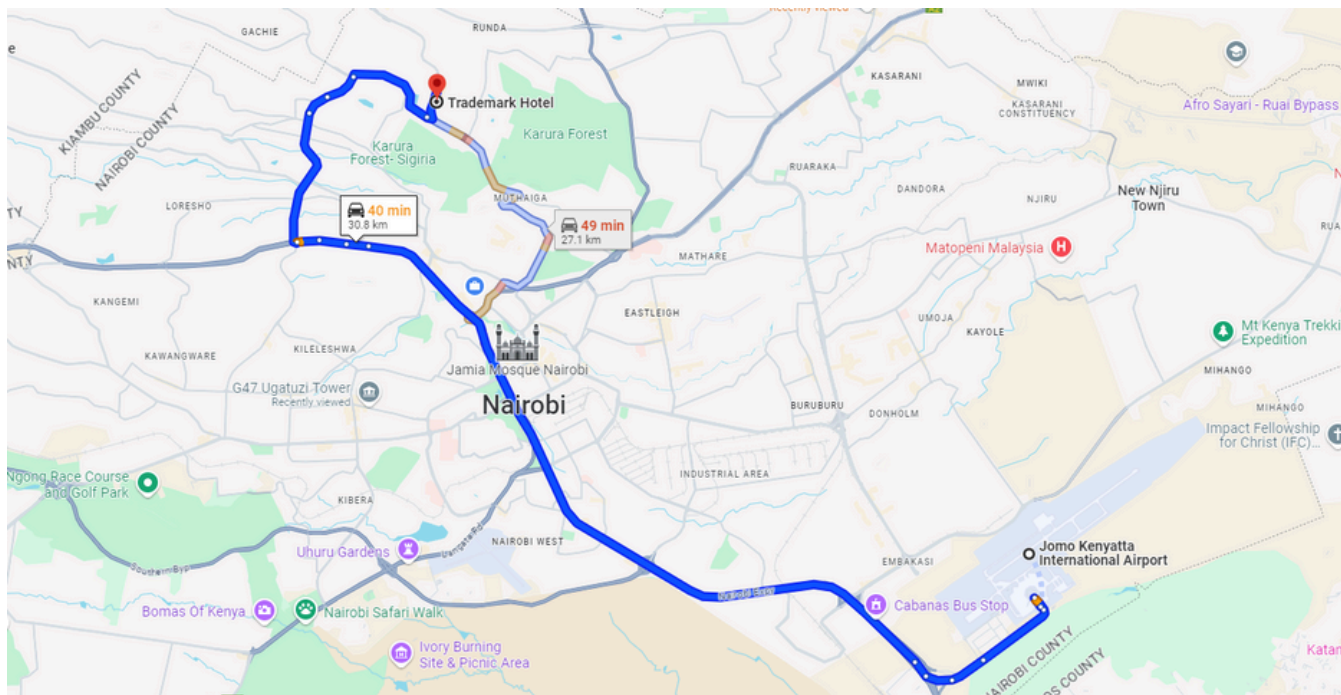

DIRECTION

From the Jomo Kenyatta International Airport (JKIA), take Mombasa Road (A104) toward the city center (Nairobi CBD). This is the main highway connecting the airport to the CBD. [Please use this link to get a google maps direction from the airport to the hotel.](#)

TRANSPORT SERVICES

A special taxi service available at the airport, **Absolute Travels**, offers one way transfer at 3,000 Kes (25 USD) from the Airport to the venue area.

UBER fares to and from the airport and the Trademark Hotel range between, 1,100 KSH to 2500 KSH (10 to 20 USD) depending on the time of day.

FOREX EXCHANGE

Currencies can be converted directly at the forex bureau located at the JKIA, at the exit of the International Arrivals.

GETTING AROUND NAIROBI

You can access Nairobi and its environs using UBER or Bolt with fares ranging between 500 KSH and 2000 KSH (15-30 USD) depending on the time of day.

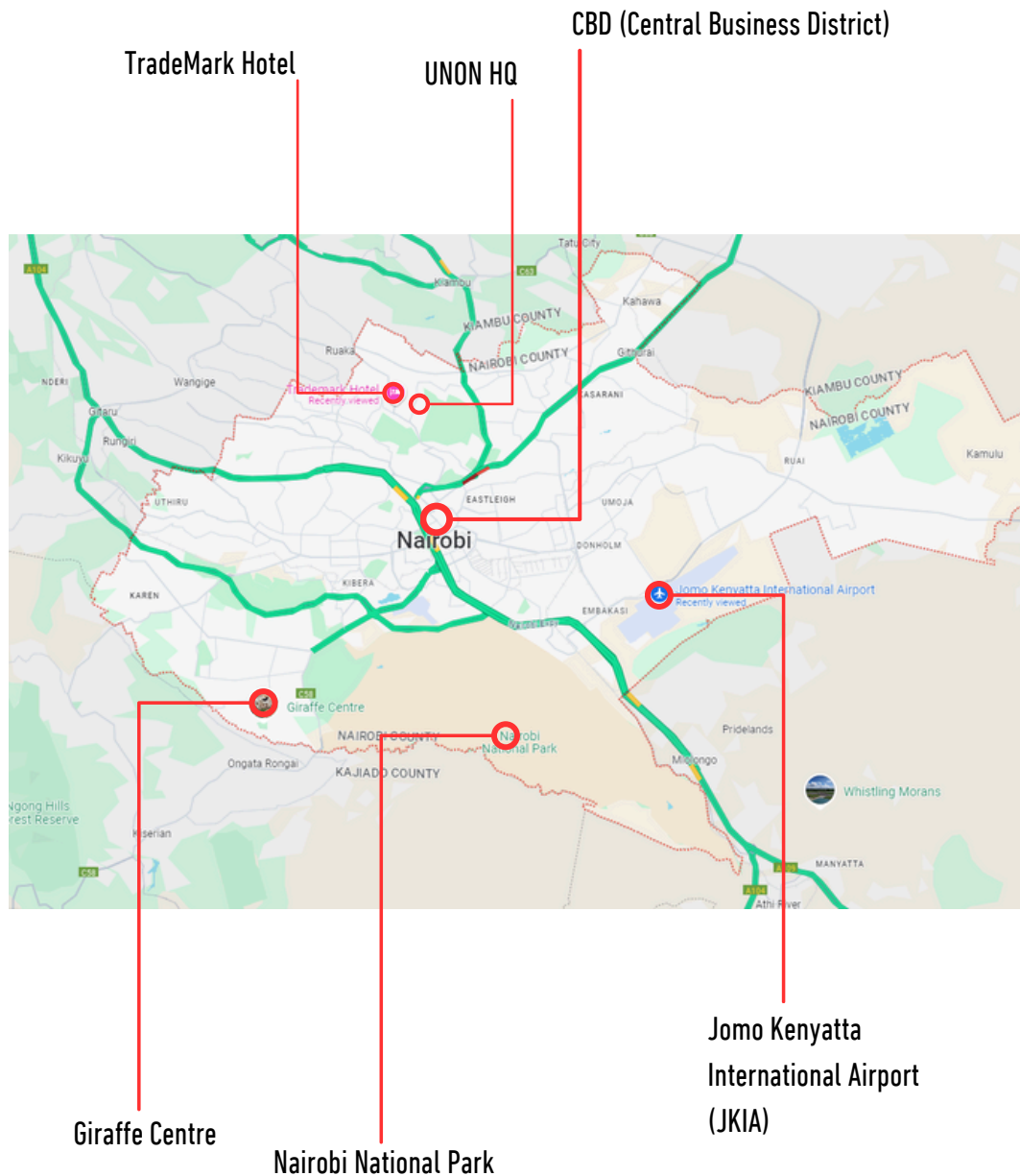

VENUE AND FACILITIES

The UNON complex is set on 140 acres of landscaped gardens and woodland, bordered by the lively Gigiri district on one side and Karura Forest on the other.

During the conference, lunch and refreshments will be served at a designated area around the venue.



<https://www.unon.org/content/security-and-safety-services>



UNITED NATIONS COMPLEX UN AVENUE, GIGIRI, NAIROBI - ROOM CR4

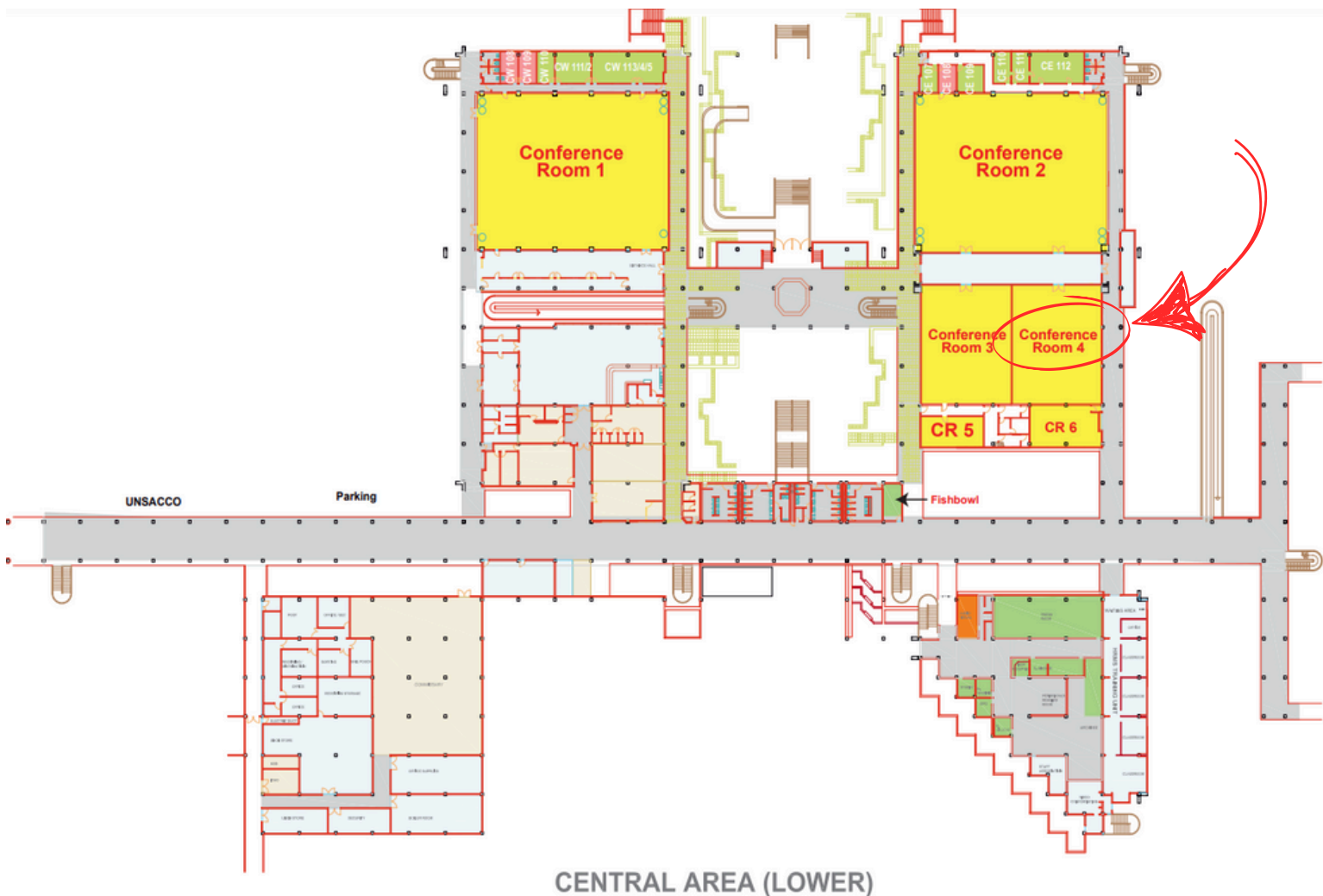



THINGS TO DO



Visit the world famous Giraffe Centre.
It's home of the Rothschild Giraffe and
Environmental Conservation Centre.



About 10Km drive out of Nairobi CBD is Nairobi National Park, the world's only wildlife capital where a great game viewing experience awaits against the city backdrop.



Visit the National Museum of Kenya and experience Kenya's past and present cultural and natural heritage.



Want to adopt an Elephant?
Spend time with the world's largest Terrestrial mammal at the Sheldrick Wildlife Trust.

EMERGENCY SERVICES

OFFICIAL CONTACT INFORMATION

Call **112** or **999** or **911** for emergency.

You can also contact the services below:



HOSPITALS

Medical Services/ Hospitals around the conference area

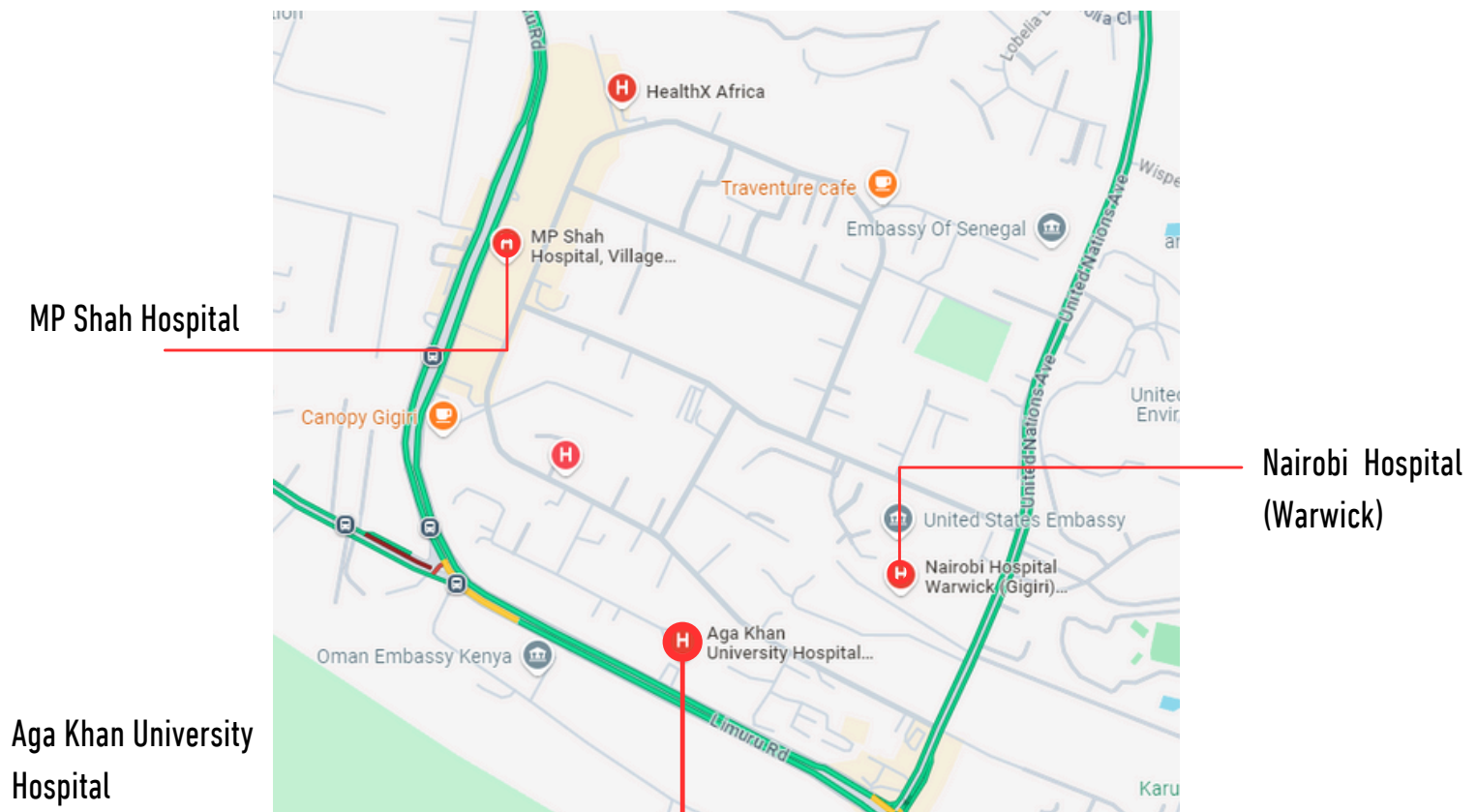

ADDITIONAL INFORMATION

CONTACT INFORMATION

If you have any questions or concerns related to your stay in Nairobi during the UN/Kenya Space4Women Expert Meeting, please reach out to the Space4Women Organizing Team:

At the **Kenya Space Agency** at the following address:

Kenya Space Agency
Pitman House, Jakaya Kikwete Road
P.O BOX 7046-00200, Nairobi

Mercy.kamau@ksa.go.ke | +254722978038
Claire.muhungi@ksa.go.ke | +254716057354

And **UNOOSA** at the following address: space4women@un.org

POWER AND VOLTAGE

The standard voltage in Kenya is 240V at a frequency of 50Hz and the standard power outlet is **TYPE G** as shown below:



ADDITIONAL INFORMATION

SHOPPING MALLS

If you are looking for an outdoor experience, you can visit malls such as Village Market, Two Rivers, Sarit Centre and Rosslyn Riviera. These malls have restaurant options and stores where you can shop during your stay in Nairobi.

TIME ZONE

The time zone in Kenya is GMT+3 (East Africa Time).

CURRENCY

The Kenyan Currency is Kenyan Shilling (KSH). Exchange Rate:
\$1= Ksh 130

LANGUAGE

In Kenya, Swahili is the national language and English is the official language. The Official Language of the Space4Women conference is English.

INSURANCE

Participants are encouraged to take out personal insurance against accidents, sickness, theft or property damage etc.



Say “Jambo” to everyone you meet...!